

Generator set
Sound-proof type
WPS350S

SPECIFICATIONS

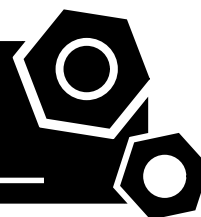

1 Standards & Conditions

Design Standards

The designs and the productions are in conformity with:

- Conformance European (CE)
- China Compulsory Certification (CCC)
- ISO8528-5:2005
- GB/T2820.5-2009

Environmental Operating Conditions

- Installation place: Outdoors or indoors (well ventilated).
- Ambient temperature: -25°C to 50°C. The coolant heater is needed when the temperature is below 5°C
- Humidity: Less than 80%.
- Altitude: Below one thousand (1000) meters.

Factory Inspection

- Inspection items.
- Protection devices working test.
- Starting ability in normal temperature.
- 50% rated power load moment capability.
- Voltage deviation and speed variation: 0%, 25%, 50%, 75%, 100%, 110% Load.

Painting Process

- Painting process specifications and colors are based on the manufacturer's standard.
- The customer could also choose the color which the manufacturer offers.

2 General Features

- Perkins engine 2206C-E13TAG2
- Close coupled to a Stamford alternator HCI444E
- Microprocessor control module PLC-920
- NADER main circuit breaker: 630A
- Rotate speed governor: Electronic fuel injection governor
- Excitation System: Self excited, SHUNT
- A.V.R. Model: AS440
- Key switch
- Emergency stop switch
- ATS (automatic transfer switch) receptacle
- 2x12V/120AH sealed for life maintenance free battery

- Lockable battery isolator switch
- Powder coated canopy
- 50°C radiator
- Oil pump on the engine
- Steel base frame with forklifts
- Vibration isolators between the engine/alternator and base frame
- Dry type air filter
- Base fuel tank for 48 hours running
- Drain points for fuel tank
- Operation Manual / Specifications

3 Equipment Specification

General technical data

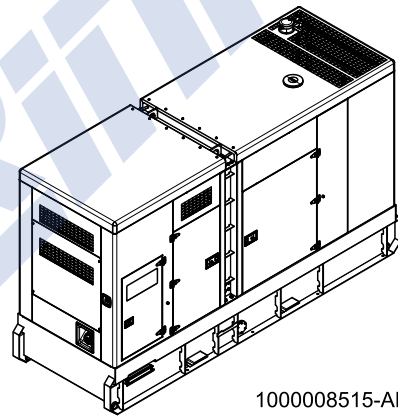

1000008515-AP1-C2

Model..... WPS350S
 Structure type R
 Tank capacity..... 800L
 Dry weight..... 4489kg
 Sound pressure level @7m80.1dB(A)
 Sound power level acc. 2000/14/EC108dB(A)
 Dimensions L×W×H..... 4242x1423x2512mm
 Standby Power 385kVA/308kW
 Prime Power 350kVA/280kW

Voltage	380V	400V	415V	440V	
Ampere	532A	505A	487A	459A	
Genset Fuel Consumption					
Frequency/Load	25%	50%	75%	100%	110%
50Hz (L/h)	N/A	38.9	56	72.2	82.6

Dck Yf' GrnghYa

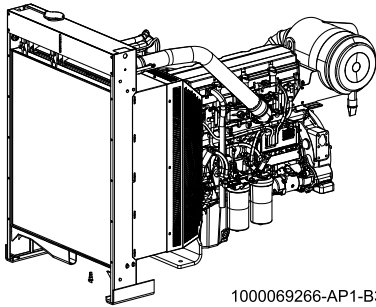

1000069266-AP1-B3

Engine Manufacturer/Brand.....	Perkins
Engine Model.....	2206C-E13TAG2
Dimensions L×W×H.....	2410×1120×1725mm
Dry Weight (approx.)	1478Kg
Number of Cylinders.....	6
Bore.....	130mm
Stroke.....	157mm
Displacement.....	12.5L
Compression Ratio.....	16.3
Type of injection.....	Direct injection
Intake System.....	Turbocharged, air-to-air charge cooled
Intake Resistance.....	N/A
Cooling System	Water cooled
Fan	Pusher
Battery Voltage.....	24V
Type of Fuel....	BSEN590 or ASTM D975 Class 1D and 2D.
Type of Oil	15W40 to API C14.
Oil Capacity	40L
Type of Coolant	Glycol mixture
Coolant Capacity	51.4L
Heat Rejected To Exhaust System	251.8kW(14101BTU/min)
Heat Rejected To Water&Oil.....	118.4kW(6630BTU/min)
Back Pressure.....	N/A
Standby Power.....	320kW
Prime Power.....	280kW
Fuel Consumption(100%load).....	75L/h

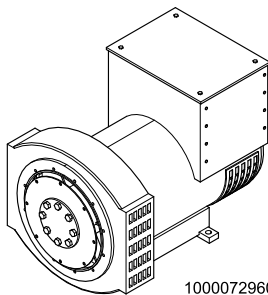

1000072960-AP1-A1

Alternator Manufacturer/Brand.....	Stamford
Alternator Model.....	HCI444E
Exciter.....	Brushless
Cooling Fan.....	Cast alloy aluminum
Windings.....	100% copper
Insulation Class.....	H
Winding Pitch.....	2/3
Terminals.....	12
Drip Proof.....	IP23
Altitude.....	≤1000m
Overspeed.....	2250rpm
Air Flow.....	0.8m³/s(50HZ),0.99m³/s(60HZ)
Voltage Regulation.....	±1.0%
Total harmonic TGH / THCat no load	< 1.5 % - on load < 5%
Telephone Interference.....	THF<2%;TIF<50

PLC-920 Control System

1000093611-AP1-E2

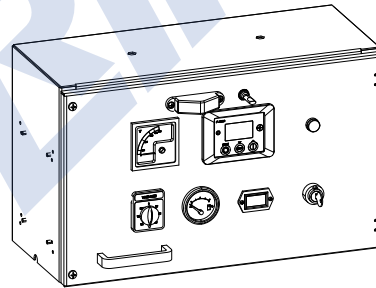

PLC-920 is an advanced control module based on micro-processor designed to control the engine via a key switch and push buttons on the front panel. The module is used to start and stop the engine and indicate fault conditions, automatically shutting down the engine and giving a true first up fault condition of an engine failure.

Standard Control Function

- Manual Engine Control Module
- Low Oil Pressure
- High Engine Temperature
- Auxiliary Shutdown
- Overspeed Protection
- Protection hold-off timer
- Charge Failure warning

4 Overall Dimensions

100008515-DR1-C2

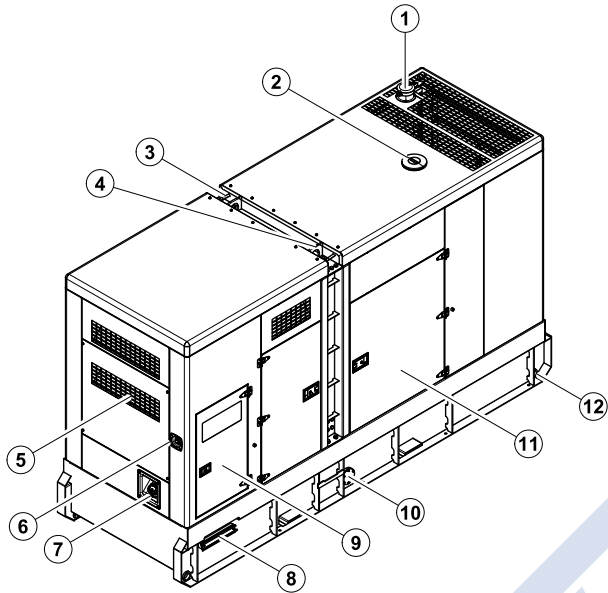

Dry weight	4489kg
Fuel tank capacity	800L
Dimensions L x W x H	4242x1423x2512mm

- ⑧ Cable trench
- ⑦ Fuel inlet
- ⑥ Emergency stop switch
- ⑤ Air inlet
- ④ Lifting lug
- ③ Roping lug
- ② Coolant inlet
- ① Exhaust gas outlet
- ⑬ Base frame
- ⑫ Tie down
- ⑪ Access door
- ⑩ Fuel drain
- ⑨ Control cabinet
- ⑯ Coolant/Oil drain hose fitting
- ⑮ External fuel inlet/return hose fitting
- ⑭ Fork lift channel

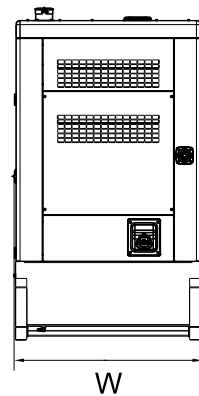
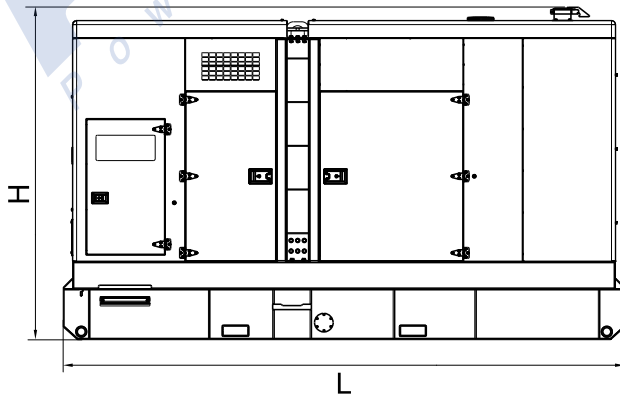
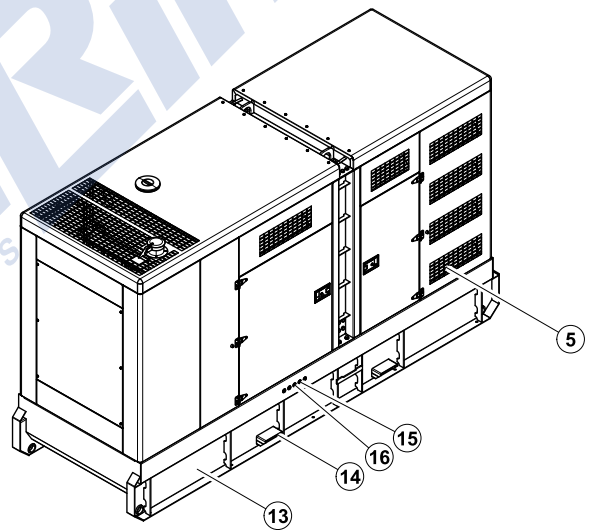

5 Control System

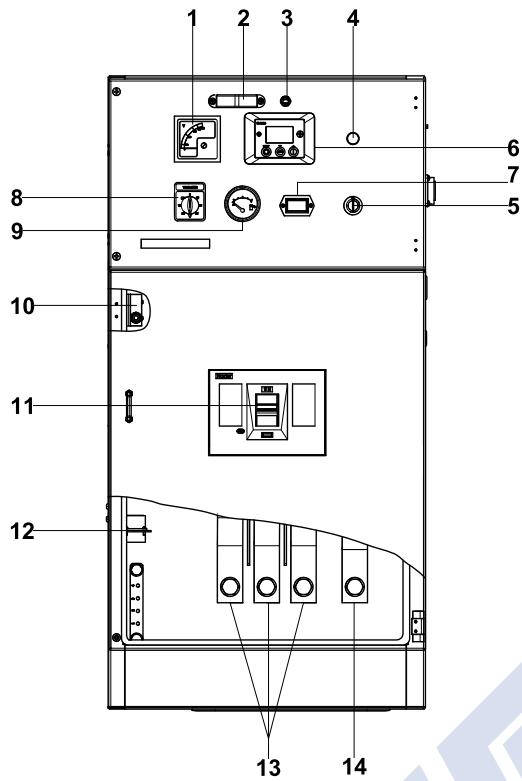

Ref.	Description
1	Voltage meter
2	Battery voltage meter
3	Control cabinet lamp switch
4	Charge indicator
5	Key switch
6	Control module
7	Time counter
8	Voltmeter change-over switch
9	Oil pressure meter
10	Limit switch
11	ATS communication interface
12	Main circuit breaker
13	Live wire terminals
14	Neutral wire terminal

Control & field wiring cabinet

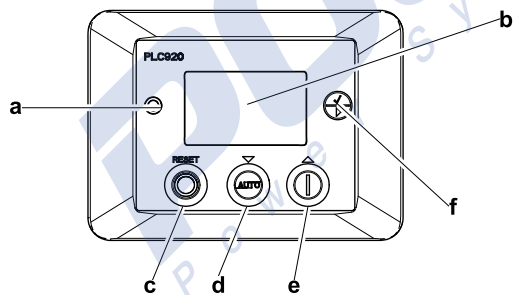

Control module

Ref.	Description
a	Alarm indicator
b	Main status display
c	Stop/reset button; Next page (Configuration mode only)
d	Auto start button; Decrease value/next item (Configuration mode only)
e	Start button; Increase value/next item (Configuration mode only)
f	Navigation button; Accept (Configuration mode only)

100008515-C2-E

05.2014

POWERLINK[®]
Power Systems

<http://www.powerlinkworld.com>

*Specification may change without prior notice. For more info.,
contact Power Link or your local distributors please.*